

2013 Wood Design Awards - Project Fact Sheet

Huu-ay-aht Multi-Purpose Building

Location: **Anacla, BC**

Height	Size		Completion	Construction Budget
2	14,530	1,350	2011-02	\$5,291,199
<i>Storeys</i>	<i>sq ft</i>	<i>sq M</i>	<i>Date</i>	<i>\$ Cdn</i>

Project Description:

Distinctive Features: - Placement at the edge of a high plateau overlooking the old village and the panoramic views of Pachena Bay:

- A crescent shaped floor plan as a gesture of embrace and of gathering around a focal point (old village, views, a fire).
- A two storey articulation to minimize footprint, maximize building envelope and acknowledge the sloped topography.
- A two storey public atrium framed by a glass curtain wall, protected by a large overhang and shaded by a micro-louvered mesh.
- A generous cantilevered wood deck, affording users and visitors outdoor access to the panoramic views.
- A contemporary interpretation of a traditional post and beam structure using glue-laminated frames in all public areas.
- Use of gang-nail trusses for the remaining of the roof structure.
- Cantilevered trusses gradually increasing their overhang as they approach the main entrance to provide a distinctive marker.
- Panelized exterior cladding of consistent lengths of pre-finished western red cedar 6" bevel boards.
- Soffits between glulam beams are 1" x 4" clear kiln dried douglas fir boards w/ 1/2" reveals.
- A fully wood clad, acoustic treated Council Chamber with access to the views and the wood deck.
- Use of glu-laminated beams for main stair and all public counters.



Environmental Performance Features:

- Minimization of site disturbance through development of a compact two storey design.
- Access to natural light for all occupied spaces.
- Exterior lighting compliant with LEED and FLAP guidelines.
- Protection of curtain wall with cantilevered overhangs and sun screen. The sunshades were designed with the help of BIM and the modelling of sun angles at winter solstice and spring and fall equinox.
- Use of geothermal (deep well) heat recovery system with hydronic radiant floors.
- Cross ventilation achieved through wind towers and low level operable windows in the atrium.
- Heat reflecting roof membrane.
- High R value building envelope.
- Low flow dual flush toilets and plumbing fixtures.
- Use of wood for the supporting structure, exterior cladding and interior finishes.
- Hydro-seeding to all construction disturbed areas with a mix of local growing grasses.

Project Images

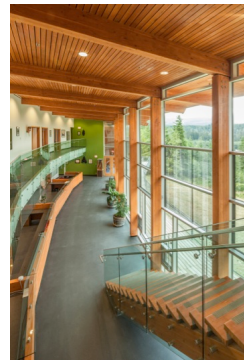
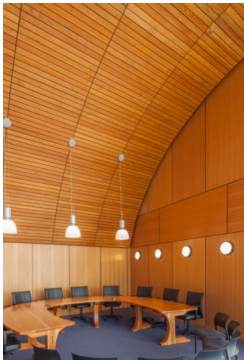

Where the Wood Was Used:

Primary Structural System	Columns, Beams & Braces	y
	Floor Structure	y
	Exterior Walls	y
	Foundation	y
	Shear Walls	y
	Bearing Walls	y
	Fire Walls	y
	Roof Structure (inc. columns and braces)	y
	Stairway & Elevator Shafts	y
	Secondary Structure	Convenience Stairs
Entrances & Canopies		y
Fire Separations		y
Enclosures for Mechanical Equipment		y

Building Project Team Members:

David Nairne + Associates		
Architect	Farshid Rafiei	
North Vancouver, BC	frafiei@davidnairne.com	604-984-3503

Michael Elkan Architectural Photography		
Photographer	Michael Elkan	
Vancouver, BC	michael@elkanphoto.com	604-261-2565

Cobalt Engineering		
Electrical Engineer	Ivan Lee	
Vancouver, BC	ILee@cobaltengineering.com	604-687-1800

Huu-ay-aht First Nation		
Owner Developer	Connie Waddell	
Port Alberni, BC	connie.w@huuayaht.org	250-723-0100

Architectural	Partitions (interior)	y
	Exterior Curtain Walls	
	Ceilings	y
	Exterior Cladding	y
	Parapets	
	Ceiling Bulkheads	
	Flooring	
	Doors	y
	Windows	
	Skylights	
	Trim, Paneling & Features	y
	Millwork	y
	Wall and Corner Guards	
	Other Architectural Woodwork	y
	Hard Landscaping & Structures	
	Perimeter Fencing	

David Nairne + Associates		
Structural Engineer	Paul Miskimmin	
North Vancouver, BC	pmiskimmin@davidnairne.com	604-984-3503

Cobalt Engineering		
Mechanical Engineer	Goran Ostojic	
Vancouver, BC	gostojic@cobaltengineering.com	604-484-8572

Horizon Engineering		
Geotechnical	Karim Karimzadegan	
North Vancouver, BC	karim@horizoneng.ca	604-990-0546

Island West Coast Developments Ltd.,		
Contractor	Greg Constable	
Nanaimo, BC	greg@iwcd.ca	250-756-9665

